

Prosperous 1



GENERAL SPECIFICATIONS

Classification	CR100 ✘ Aluminium Alloy, Crew Boat, LSC, Semi-SWATH, Coastal Service
Flag State	Taiwan (R.O.C)
Port of Registry	Taichung
IMO Number	9899674
Call Sign	BR4303
Year of Construction	2020
Type of Vessel	Crew Transfer Vessel

MAIN PARTICULARS

Length	23.93 m
Breadth	10.09 m
Depth	4.12 m
Gross Tonnage	196 tons
Net Tonnage	58 tons
Top Speed (100% MCR)	23 Knots
Service Speed (80% MCR)	19 Knots

ENGINE POWER & PROPULSION

Main Engines	2 x Caterpillar C32
Total Power	1193 kW
Propellers	2 x 5 Blade FPP, 1200mm dia
Bow Thrusters	2 X 60hp Hydraulic
Generators	1 x Caterpillar C2.2, 24.5kVA, 3ø
Gearbox	2 x Reintjes twin speed ZWVS 730

CARGO

Deck Space	75m ² FWD, 80m ² AFT
Deck Cargo	30 tons
Deck Crane	1 x Palfinger PK23500M on Aft
Deck Strength	2 t/m ²
Fuel Transfer Pumps	2 x 120 l/min @40m head
Pressure Wash Pump	1 x 25 l/min @ 300 bar

TANK CAPACITIES

Fuel Oil	36.2 m ³
Fresh Water	31.7m ³
Grey Water	3m ³
Black Water	3m ³
Dirty Oil	0.6m ³

NAVIGATION EQUIPMENT

Radar 1	1 x Furuno FAR1513
Radar 2	1 x Furuno DRS 4DNXT
GPS	1 x Furuno GP170
Satellite Compass	1 x Furuno SC-70
Echo Sounder	1 x Furuno BLT 28BL-6HR
Autopilot	1 x Simrad AP80
AIS	1 x Furuno FA170
ECDIS	Furuno ECDIS
GPS Compass	1 x Koden KGC222

ACCOMMODATION

Passenger Seating	12 Reclining suspension seats
Vessel Crew	4 Crew Cabins
Galley	Microwave, Fridge, Freezer, Oven & 4 Hob Cooker, Water boiler
Entertainment	2 x 32" LCD TV in the Saloon

COMMUNICATION EQUIPMENT

VHF	2 x Sailor RT6222 VHF DSC
Internal Communication	1 x Furuno LH5000
NAVTEX	1 x Furuno NX700
VHF Portable, 2 Way	2 x Jotron TRON TR20
MF/HF Transceiver	1 x Sailor 6310 MF/HF DFC Radio
Crew Finder	Seamarsall SAR Finder
EPIRB	1 x Jotron TROM 60 GPS
SART	1 x Jotron TRON AIS SART

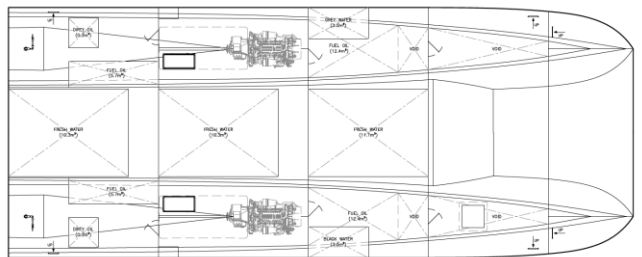
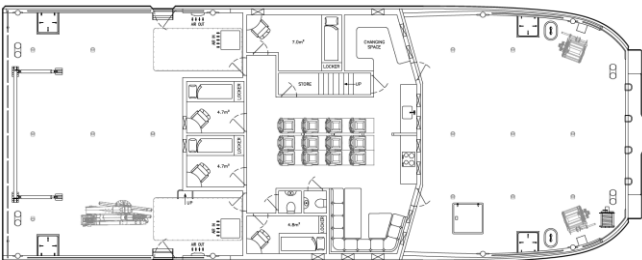
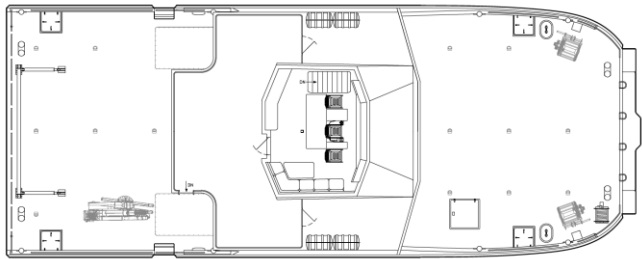

For enquiries please contact:

Prosperous Wind Shipping Limited
 5F - 5, No. 29, Section 1, Minsheng East Road,
 Zhongshan District, Taipei City 104, Taiwan (R.O.C.)
bob@mainprizeoffshore.co.uk
sreekumar.s@pacificradianc.com